

### 1100 SERIES

#### FEATURE

Insulator Material : PBT UL94V-0  
 Contact Material : Alloy Copper  
 Plating : Selective Gold Plating On Contact Area  
 100μ" Tin Plating On Tail Section  
 50μ" Nickel Underplating

#### SPECIFICATION

Current Rating : 15 Ampere  
 Contact Resistance : 10 milliohms maximum  
 Insulation Resistance : 5000 megohms minimum  
 Dielectric Withstanding Voltage : 1200VAC  
 Operation Temperature Range : -55 C to +105 C

#### ORDERING INFORMATION

1100 - □□□ - L - R - D - C - □ - A AC

**No. Of Contacts** ↓

**Housing Type**

L : Low Profile 14.61 mm

**Mating Contact Type**

R : Regular Type

**Contact Style**

D : Dip Type (180°)

↓ **Other Custom Options**

A : Row to Row 5.08 mm

AC : Contact Material Alloy Copper

↓ **Plating Option**

↓ **Tail Length**

C : 4.50 mm

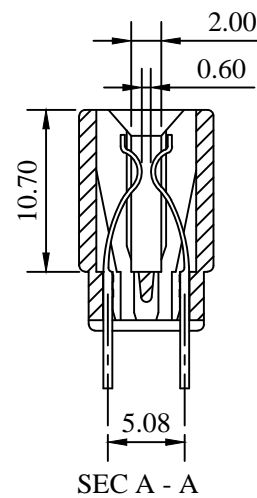
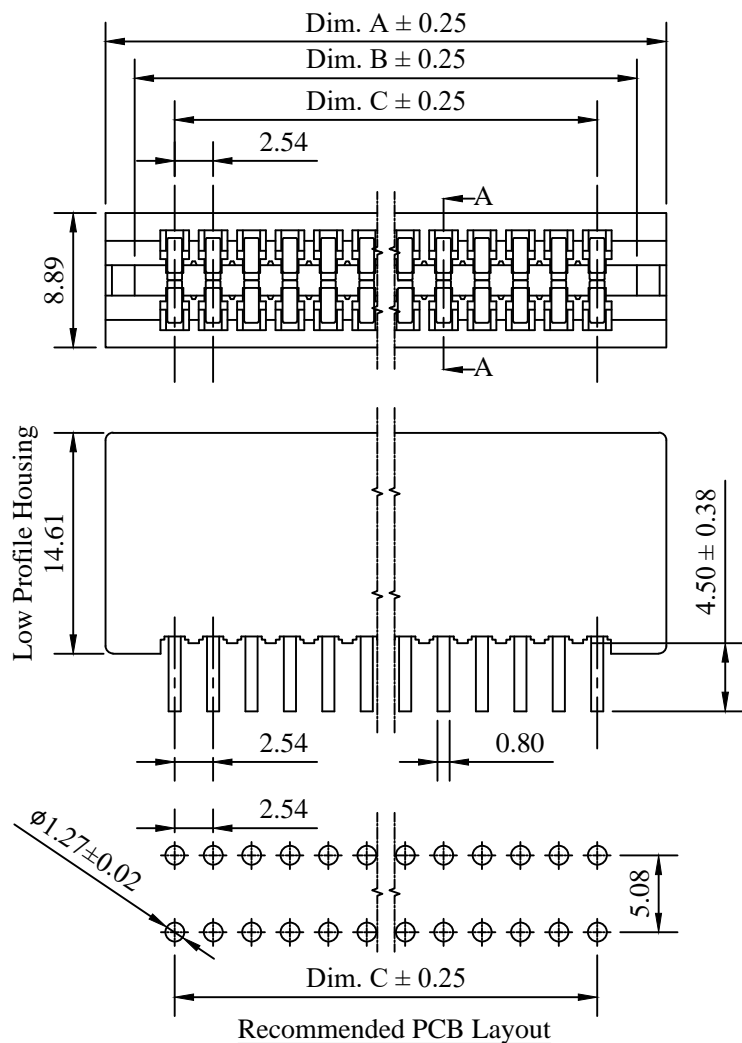

No. of Contacts	Dimensions (Dim.)			Plating Code	
	A	B	C		
04/08	16.76	12.90	7.62	1	10μ"
06/12	21.84	17.98	12.70	2	G/F
10/20	32.00	28.14	22.86	3	3μ"
20/40	57.40	53.54	48.26	4	5μ"
25/50	70.10	66.24	60.96	5	G/F Overall
36/72	98.04	94.18	88.90	6	30μ"
				7	Tin Overall
				8	15μ"
				9	20μ"

Title : Customer Drawing		Type : Edgcard Connector		CIAN SHIN INDUSTRIAL CO.,LTD			
Part No. : 1100 - □□□ - L - R - D - C - □ - AAC				謙鑫實業股份有限公司			
Description :				Tolerances Unless Otherwise Specified :			
1100 Series Low Profile Housing 14.61 mm				X. ± 0.50			
Pitch 2.54 mm, Row to Row 5.08 mm				.X ± 0.38			
Tail Length 4.50 mm				.XX ± 0.25			
				X.° ±			
				.X° ±			
				.XX° ±			
DWG No. : 010 - 0000 - 511.15A	DATE : 28 - Nov. - 2022		Dim.	Scale	Sheet	Rev.	
APPD. : James C.	CHK. : Connie Z.		DRW. : Bryant C.	mm	n/a	1 of 1	X1